

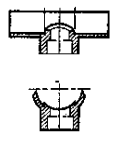



No.	Imperial Size	Ref	PVC £	Ref	ABS £	No.	Metric Size	Ref	PVC £	No.	Metric Size	Ref	PVC £
1	3/4" x 1/2"	36PRC4P01	£ 0.97	36PRC4A01	£ 1.16	1	20 x 16	36PTR0601	£ 0.65	18	75 x 63	36PTR0618	£ 3.98
2	1" x 1/2"	36PRC4P02	£ 1.25	36PRC4A02	£ 1.54	2	25 x 16	36PTR0602	£ 0.78	19	90 x 50	36PTR0619	£ 2.00
3	1" x 3/4"	36PRC4P03	£ 1.25	36PRC4A03	£ 1.54	3	25 x 20	36PTR0603	£ 0.91	20	90 x 63	36PTR0620	£ 2.00
4	1 1/4" x 1"	36PRC4P04	£ 1.74	36PRC4A04	£ 2.01	4	32 x 16	36PTR0604	£ 1.00	21	90 x 75	36PTR0621	£ 7.00
5	1 1/2" x 3/4"	36PRC4P05	£ 2.06	36PRC4A05	£ 2.48	5	32 x 20	36PTR0605	£ 1.00	22	110 x 63	36PTR0622	£ 9.19
6	1 1/2" x 1"	36PRC4P06	£ 2.06	36PRC4A06	£ 2.58	6	32 x 25	36PTR0606	£ 1.00	23	110 x 75	36PTR0623	£ 9.19
7	1 1/2" x 1 1/4"	36PRC4P07	£ 2.32	36PRC4A07	£ 2.58	7	40 x 20	36PTR0607	£ 1.29	24	110 x 90	36PTR0624	£ 9.19
8	2" x 1"	36PRC4P08	£ 2.96	36PRC4A08	£ 3.43	8	40 x 25	36PTR0608	£ 1.29	25	125 x 75	36PTR0625	£ 16.30
9	2" x 1 1/4"	36PRC4P09	£ 2.96	36PRC4A09	£ 3.43	9	40 x 32	36PTR0609	£ 1.29	26	125 x 90	36PTR0626	£ 16.30
10	2" x 1 1/2"	36PRC4P10	£ 2.96	36PRC4A10	£ 3.43	10	50 x 25	36PTR0610	£ 1.55	27	125 x 110	36PTR0627	£ 16.30
11	3" x 1 1/2"	36PRC4P11	£ 8.10	36PRC4A11	£ 9.20	11	50 x 32	36PTR0611	£ 1.55	28	140 x 90	36PTR0628	£ 21.18
12	3" x 2"	36PRC4P12	£ 8.35	36PRC4A12	£ 9.20	12	50 x 40	36PTR0612	£ 1.55	29	140 x 110	36PTR0629	£ 21.18
13	4" x 3"	36PRC4P13	£ 11.04	36PRC4A13	£ 12.74	13	63 x 32	36PTR0613	£ 2.06	30	160 x 125	36PTR0630	£ 21.18
14	6" x 4"	36PRC4P14	£ 34.01	36PRC4A14	£ 39.60	14	63 x 40	36PTR0614	£ 2.06	31	160 x 110	36PTR0631	£ 28.62
15	8" x 6"	36PRC4P15	£ 73.78	36PRC4A15	£ 83.41	15	63 x 50	36PTR0615	£ 2.06	32	160 x 125	36PTR0632	£ 28.62
16	10" x 8"	36PRC4P16	£ 210.87	-	-	16	75 x 40	36PTR0616	£ 3.98	33	160 x 140	36PTR0633	£ 28.62
17	12" x 10"	36PRC4P17	£ 237.37	-	-	17	75 x 50	36PTR0617	£ 3.98	34	200 x 160	36PTR0634	£ 49.64



PVC Pipe Saddle Solvent

Size	Price
3" x 2"	£ 17.50
4" x 2"	£ 19.50
6" x 2"	£ 30.50
6" x 4"	£ 37.00
8" x 2"	£ 43.50
8" x 4"	£ 45.50
10" x 4"	£ 49.50

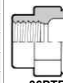
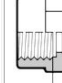
Connection by use of Cement - Male * Female Make sure that all surfaces are clean and grease free before application of solvent cement to both services with a brush.

BSP Reducing Bushes & Sockets PVC									
No.	Size (BSP * BSP)	Ref	M/F	Ref	F/F	Ref	F/M		
1	3/4" x 1/2"	36PTR3201	£ 2.51	36PMR201	£ 3.28	36PTR32R01	£ 3.28		
2	1" x 1/2"	36PTR3202	£ 2.51	-	-	-	-		
3	1" x 3/4"	36PTR3203	£ 2.51	36PMR203	£ 3.93	36PTR32R03	£ 3.93		
4	1 1/4" x 1/2"	36PTR3204	£ 4.06	-	-	-	-		
5	1 1/4" x 3/4"	36PTR3205	£ 4.06	-	-	-	-		
6	1 1/4" x 1"	36PTR3206	£ 4.06	36PMR206	£ 5.40	36PTR32R06	£ 5.40		
7	1 1/2" x 3/4"	36PTR3207	£ 4.95	-	-	-	-		
8	1 1/2" x 1"	36PTR3208	£ 4.95	-	-	-	-		
9	1 1/2" x 1 1/4"	36PTR3209	£ 4.95	36PMR209	£ 6.23	36PTR32R09	£ 6.36		
10	2" x 1"	36PTR3210	£ 7.91	-	-	-	-		
11	2" x 1 1/4"	36PTR3211	£ 7.91	-	-	-	-		
12	2" x 1 1/2"	36PTR3212	£ 7.91	36PMR212	£ 7.64	36PTR32R12	£ 7.70		
13	3" x 1 1/4"	36PTR3213	£ 15.79	-	-	-	-		
14	3" x 2"	36PTR3214	£ 15.79	-	-	-	-		
15	3" x 2 1/2"	36PTR3215	£ 15.79	36PMR215	£ 21.06	36PTR32R15	£ 21.06		
16	4" x 2"	36PTR3216	£ 25.67	-	-	-	-		
17	4" x 3"	36PTR3217	£ 25.67	36PMR217	£ 37.15	36PTR32R17	£ 37.15		



M/F = Male BSP X Female BSP
F/F = Female BSP X Female BSP
F/M = Female X Male BSP
Use PTFE tape for thread sealing when tightening BSP threaded bushes as needed. Check fit of thread before tape winding.

Grey Coloured PVC Bushes are mostly supplied with hexagons for securing BSP threads are parallel!

PTFE Sealing Tape		PP Pouring Funnels 6"		Cement PVC				Cement ABS			
Description	Weight	Ref	Price	Description	Weight	Ref	Price	Description	Weight	Ref	Price
Ref: 36PTFE	£0.36 / Reel	Ref: 36PBM216	£0.95 each	PVC with Brush *	100ml	36PRCO100	£ 2.95	ABS Tin	500ml	36PACO500	£ 5.60
				PVC with Brush *	250ml	36PRCO250	£ 5.17			MEK Cleaner	
				PVC Tin	500ml	36PRCO500	£ 11.00			MEK	500ml
										36PRMO500	£ 8.78

Worm Drive Hose Clips 8MM & 12.5MM				Worm Drive Hose Clips				Unex Clips			
Stainless 304				Mid Steel				Stainless 304			
											
Size	Band	Ref	£/Each	Size	Ref	£/Each	Size	Ref	£/Each		
11mm-25mm	8mm	36MSS01	£ 0.32	12mm-20mm	36MMS20	TBA	7.4mm-10mm	36M4UNEXD10	£ 0.75		
14mm-32mm	8mm	36MSS02	£ 0.37	16mm-27mm	36MMS27	TBA	9mm-14mm	36M4UNEXD14	£ 0.80		
18mm-38mm	8mm	36MSS03	£ 0.33	20mm-32mm	36MMS32	TBA	14mm-19mm	36M4UNEXD19	£ 0.90		
25mm-44mm	8mm	36MSS0310	£ 0.37	35mm-50mm	36MMS50	TBA	17mm-22mm	36M4UNEXD22	£ 1.10		
44mm-63mm	8mm	36MSS0515	£ 0.55	40mm-60mm	36MMS60	TBA	22mm-27mm	36M4UNEXD27	£ 1.50		
32mm-50mm	8mm	36MSS0516	£ 0.60	50mm-70mm	36MMS70	TBA	-	-	-		
40mm-60mm	8mm	36MSS0517	£ 0.90	70mm-90mm	36MMS90	TBA	-	-	-		
50mm-70mm	8mm	36MSS05	£ 1.73	100mm-120mm	36MMS120	TBA	-	-	-		
33mm-57mm	12.5mm	36MSS06	£ 1.10	-	-	-	-	-	-		
52mm-76mm	12.5mm	36MSS07	£ 1.20	-	-	-	-	-	-		
84mm-108mm	12.5mm	36MSS08	£ 1.40	-	-	-	-	-	-		

Screwdriver/Hexagon Nut as standard for tightening

Flat Rubber Gaskets						Maclow Pipe Clips		
For BSP I.D. & O.D. 2mm & 3mm thick						Grey Polypropylene Push Fit type with screw fixing hole.		
								
Size	Fits	Plain / Pipped Type	Ref	£/Each	Size	Ref	£/Each	
3/8"	Male	Pipped	36PG0700	£ 0.10	3/8"	36PM08	£ 1.00	
1/2"	Male	Pipped	36PG0701	£ 0.10	1/2"	36PM08	£ 1.00	
3/4"	Male	Pipped	36PG0703	£ 0.11	3/4"	36PM11	£ 1.08	
1"	Male	Plain	36PG0703A	£ 0.13	1"	36PM13	£ 1.22	
1 1/4"	Male	Plain	36PG0704	£ 0.20	1 1/4"	36PM16	*£ 1.27	
1 1/2"	Male	Plain	36PG0705	£ 0.21	1 1/2"	36PM19	*£ 1.61	
2"	Male	Plain	36PG0706	£ 0.27	2"	36PM23	*£ 1.67	
1/2"	Female	Pipped	36PGF05	£ 0.10	3"	36PM30	*£ 5.00	
3/4"	Female	Pipped	36PGF07	£ 0.15	4"	36PM40	*£ 5.35	
1"	Female	Pipped	36PGF10	£ 0.21	6"	36PM60	*£ 9.80	
1 1/4"	Female	Pipped	36PGF12	£ 0.27				
1 1/2"	Female	Pipped	36PGF15	£ 0.33				

Variation in material and sizes likely.

Strap tops available on all (*).