

Everyvalve Ltd
TIDAL FLAP VALVE IN CAST / S.G. IRON

Used for outfall flow from walls or pipe flange ends into rivers or the sea. SS Anti Tamper proof hinge pins and bronze bushes. Epoxy finish of unit provide a corrosion resistant performance. CI & S.G Iron Body. Bronze face trim and lifting hooks are standard.

Ref	Bore	A mm	B mm	C mm	P . C . D mm x holes	Weight Kgs	Price
23MTF30	80mm	200	225	125	4 x 160	5	£ 60.00
23MTF40	100mm	220	245	135	4 x 180	7	£ 85.00
23MTF60	150mm	285	315	172	4 x 240	11	£ 125.00
23MTF80	200mm	340	370	204	4 x 295	17	£ 180.00
23MTF81	250mm	400	440	233	4 x 355	25	£ 255.00
23MTF82	300mm	460	475	280	4 x 410	34	£ 330.00
23MTF83	350mm	540	591	321	4 x 470	37	£ 465.00
23MTF834	375mm	540	591	321	4 x 495	37	TBA
23MTF84	400mm	580	621	331	4 x 525	44	£ 580.00
23MTF85	450mm	640	695	375	4 x 585	53	£ 680.00
23MTF86	500mm	715	758	400	4 x 650	62	£ 855.00
23MTF87	600mm	840	867	447	4 x 770	78	£ 1,055.00

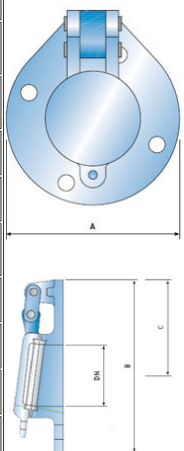

Rubber Expansion Joints - JP01

Applications:-Mountable on pipe work to absorb - Expansions, Contractions, Oscillations & Vibrations. Diminution of : Hammering, Noise & Electrical Conductivity.
Typical uses are :-For Water Services within the specification as shown below.

General Specifications:-

Temperature Range -15°C to +75°C (Other Temps on Call)
Vacuum 740mm Hg
Pressure 16 Bars at ambient
Connections PN10 (to 150mm) & PN16 (150mm+)
Casing Sleeve Neoprene + reinforced canvas nylon
Flanges Dip Galvanised Steel

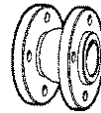
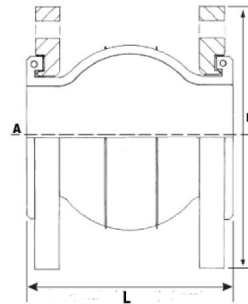

Table of Sizes

Ref	Size	Flgd	L	H	C	E	T	A	Weight Kgs	Price
23MJP0312	32mm	PN10	95	140	8	4	8	15	3	£ 60.00
23MJP0315	40mm	PN10	95	150	8	4	8	15	4	£ 60.00
23MJP0320	50mm	PN10	105	165	8	5	8	15	4	£ 55.00
23MJP0325	65mm	PN10	115	185	12	6	10	15	6	£ 65.00
23MJP0330	80mm	PN10	130	200	12	6	10	15	7	£ 75.00
23MJP0340	100mm	PN10	135	220	18	10	12	15	7	£ 95.00
23MJP0350	125mm	PN10	170	250	18	10	12	15	11	£ 115.00
23MJP0360	150mm	PN10	180	285	18	10	12	15	14	£ 165.00
23MJP0380	200mm	PN16	205	340	25	14	22	15	21	£ 230.00
23MJP0381	250mm	PN16	240	405	25	14	22	15	25	£ 400.00
23MJP0382	300mm	PN16	260	460	25	14	22	15	38	£ 500.00
23MJP0383	350mm	PN16	265	520	25	16	22	15	50	£ 820.00
23MJP0384	400mm	PN16	265	580	25	16	22	15	60	£ 1,110.00
23MJP0385	450mm	PN16	265	640	25	16	22	15	70	£ 1,165.00
23MJP0386	500mm	PN16	265	715	25	16	22	15	89	£ 1,335.00
23MJP0387	600mm	PN16	254	840	25	16	22	15	95	£ 2,405.00



L=Length : H=Flange OD : C=Compression (Max) : E=Extension (max) : T=Side Shift (Max) : A=Angular Shift (Deg)
Wt=Weight in Kg : Dimensions in mm : Sizes are bore sizes : Other option are:- Tie Bar Accessories : BSP ended also available
Steel and Stainless types for steam **Important :-** Be sure there is a contained assy. in a pipeline for correct working performance. If in doubt please consult qualified advice for your consideration.

PLEASE NOTE : Prices subject to change without prior notice.